



Decent Housing and Safe Environment for Children in brick kiln

A pilot project on housing of brick kiln workers in LBM brick kiln of Jinnaram, Andhra Pradesh

BACKGROUND

Migration is a complex phenomenon impacting the lives of the moving population. In India there are 400 million internal migrants out of which seasonal migrants constitute close to 30 million people. As per UNESCO reports, 2013, children constitute around 15% of the total migrant population in India. When families migrate together, children are compelled to drop out of school. Cramped and unhygienic living conditions also rob them of healthcare, nutrition and social protection, which is available to non-migrant children at their home place. Amidst negligible support and system, care and development of these children suffer, their dreams crushed, their childhood lost!

Aide et Action has been working with migrant children in Andhra Pradesh since 2009. The work includes mapping of migrant children, setting up schools at worksites, mobilizing text books and collaborating with the Dept. of Education, Govt. of Andhra in bringing in migrant children into the school system.

Realizing the plight of children living in unhealthy environment in brick kiln, MiRC, Aide et Action International-South Asia collaborated with Bernard Van Leer Foundation (BvLF) to pilot decent housing for migrant families and creating safe and healthy environment for children of migrant brick kiln workers. The Hyderabad regional office undertook the initiative on the ground.

NEED FOR DECENT HOUSING IN BRICK KILN

Half of the life of a migrant child is spent in unhealthy, polluted, congested, dusty and unfriendly environment which do not have basic life supporting systems and services. This results in the poor physical, mental and emotional growth of the children. Because of their isolated dwellings, often these children do not get the attention of government machineries in accessing nutrition, basic health and education facilities which is a fundamental right of a child.

Families working at the kilns usually live next to the work site in tiny, dingy, makeshift huts with low ceilings (3.5 feet high), which they erect out of broken bricks and roofing materials

collected from the surrounding areas. There is no separate space for cooking or bathing. The dwellings are so small that one has to crawl into the house to live in. There is no adequate ventilation inside the houses which results in absorption of heat and smoke due to cooking which is performed inside the house. The houses are also vulnerable to fire and don't have any escape in case of emergency. It is in these circumstances that families survive for eight to nine months every year.



Further, access to clean drinking water, nutrition, health and support is non existence. In such situation children face acute health related ailments. Perturbed by the plight of children living in difficult situation in worksite, Aide et Action International and Bernard van Leer Foundation came forward to take up the decent housing pilot project with an objective to demonstrate a replicable decent housing model that ensures safety and provides healthy dwelling environment for the children and families living in brick kilns.

PLANNING OF THE HOUSING PROJECT

Location: After searching for two-there brick kiln locations finally the LBM brick kiln in Annaram village of Jinnaram Mandal in Medak district was selected for the housing site. The owner of the brick kiln Mr. Babu Rao agreed to cooperate and contribute for the housing model. The site is around 20 kilometers from Hyderabad city and has over 100 migrant families from Odisha working in the brick kilns. The worksite had around 65 children in the 0-14 years of age group.

Design and Construction: 23° Design Shift, the architect firm headed by Mr. Saket Singh and his young team was approached to provide the design and technical support for the project. Although, the architect firm had never designed housing for the poor workers and children, it had to do a number of researches about the location, cultural aspect of housing of people from Odisha and the worksite condition, prior to launching the project.

The location of the housing site in the brick kiln was chosen in the South West corner to avoid the dust and other effluents coming from the kilns.

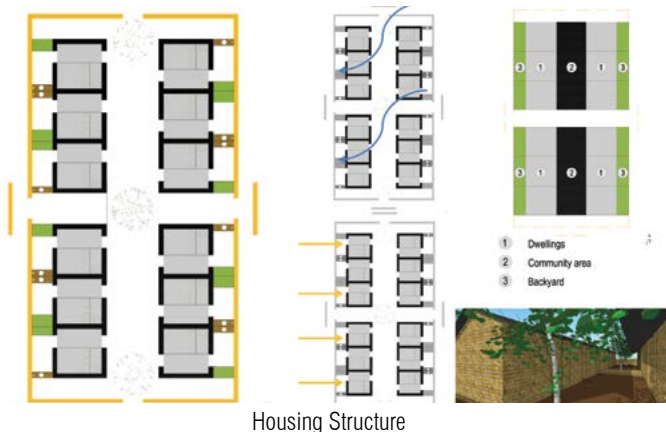

- The entire housing project site consists of 3200 square feet which has dwelling units, community space or child friendly space and a backyard.
- The dwelling area was designed in such a way that sleeping area for adults, children are demarcated besides providing spaces for storage. While the cooking area was provided in the courtyard/backyard.
- Locally available clay bricks, clay as bonding material and a tin roof were used for construction of the housing project.
- Further, cavity walls construction method was used for constructing walls such that the dwelling spaces are cooler in summer. Ventilation shafts have been provided in between the cavity walls such that the heat is radiated out.
- A separate toilet block with two lavatories and bathing space is constructed near the vicinity of the dwelling spaces. A percolation pit made of brick and brickbats was dug connecting the toilets for seepage of water and human excreta.

GROUNDING OF THE PROJECT

The housing project work started on 18th February, 2013. It took about 24 to 26 man days for constructing 4 units of 12 dwelling spaces, community and child friendly spaces, backyard, low height boundary wall and a toilet block. The entire cost incurred for constructing the house which includes two bathrooms and two lavatories was around Rs. 300,000. Besides, the bricks and the clay mud were supplied by the owner of the brick kiln which was locally available in the worksite.



Unveiling of Decent Housing: Formally the decent houses were inaugurated on 16th April, 2013 in the presence of officials from BVLF, Aide et Action, young colleagues from 23° Design Shift, brick kiln owners from adjoining facilities, Government officials from Education, Women and Child, Deputy Tehsildar from Jinnaram Mandal. The housing blocks and the child space was handed over to the brick kiln owner. The brick kiln labourers and particularly the women those who were allotted the housing have expressed their happiness and finally found a house which will be much more spacious, wide and decent.



Padma

The houses have profoundly changed the experience of seasonal migrant families, such as for the forty year old Timan Karvel, his wife Padma and their four children, who have migrated to work at the brick kiln for the last ten years. "I used to struggle a lot to take care of my kids and belongings," says Padma. "During summer, we used to sleep outside and my kids inside the hut. When it rained, we all used to huddle inside and worry about whether the wind would blow away the tarpaulin roof. Now our living place is much better and my kids are also going to the child learning centre," Padma added.

IMMEDIATE IMPACT OF THE DECENT HOUSING:

- The 12 dwelling spaces have been occupied by 11 migrant families from Odisha.
- One dwelling space was allocated to the registered medical practitioner where he stores essential medicines and uses it for consultation purposes for treating the families residing in the brick kilns.
- The child friendly space in between the dwelling units is being utilized as worksite school in which 65 children of the Odiya migrant families are being taught in their mother tongue by the

educational volunteers from Odisha employed by the Rajiv Vidya Mission (SSA) of Medak District.

- The migrants have a separate space for cooking which has been provided in the courtyard/backyard.
- A separate toilet block with two lavatories and bathing space has helped reduce the system of open defecation.
- The 3200 square feet area of the housing site has helped the people to live in a spacious house where they can enter the house without bending.
- The community space or child friendly space and a backyard have given the migrants and their children space to spend time under the roof and play in a safe environment.
- The ventilation shafts provided in between the cavity walls has helped the heat coming out of the fire while cooking, radiate out easily.
- Cavity wall construction method has helped in keeping the rooms cooler in summer season.
- The owner of LBM brick kiln expressed his happiness to extend those facilities to other families as well. He also wants to build similar houses in other places in his brick kilns to accommodate more number of migrant families in the coming season.
- The owners of other nearby brick kilns are also interested in replicating the same in their brick kilns in the coming brick kiln season.
- Once the space for the children was created, the number of children increased drastically. The children of LBM brick kiln and nearby brick kilns are much happier than before as now they have a place to play. Children who were helping their parents in the brick kilns also came to this place to spend their time with their friends.
- Teaching learning materials, toys and the peer groups helped the children to get education and stay safe. The idea of running a worksite school has helped children to get early education.
- It is also acknowledged by the employer that the children have not met with any accidents this year and also health related



complaints have reduced in comparison to previous years because of the separate space provided to children where they are safe.

- The perception of the parents also changed towards the safety and security of their children. Parents feel children are safer in the model house than around the worksite.
- Cooking space provided to the migrant families was safer as it was at the backyard where children rarely go. On the other hand women are also free from hazardous smoke.
- Provision of toilet has made adolescents and women specially the pregnant and lactating mothers more comfortable. They feel safer in terms of health and hygiene and safety and security as they need not have to go for open defecation.

The living conditions of migrant workers who constitute 30% of the 400 million unorganised workers in India do not find a decent and healthy space of living. Most of the workers who move from other states largely work in brick making; building, highway construction, stone crusher and some agriculture field workers, live a precarious life at the worksite. Despite the government mandate to provide basic facilities like housing and safety equipment to the workers, the same is yet to be realised. The BVLFF –Aide et Action and the owners willingness has brought a remarkable impact on the lives of the people.

We sincerely thank Aide et Action Regional colleagues, 23° Design Shift for their innovation, Mr. Babu Rao for his field support and contribution and the Govt. of Andhra Pradesh for linking midday meal and running the schools in the space created for children.



Existing Houses



Model Houses

HOUSING PROJECT IN NEWS

NGOs set model house example for kids at brick kilns

Ritesh Kumbhakar / The Hindu

Millions of children are sent to work in brick kilns to earn money for their families. Lack of proper education in such places negatively affects their education, who are unable to carry papers to the school, and the A.P. government is not taking any initiative to help them.

One of the model houses built in Andhra Pradesh is shown in the image. The model houses have been constructed to set an example for brick kiln owners as they are made in the model and constructed in the same way as the brick kiln houses. The brick kiln houses are made of brick and are built in the same way as the brick kiln houses. The brick kiln houses are made of brick and are built in the same way as the brick kiln houses.



One of the model houses built in Andhra Pradesh is shown in the image. The model houses have been constructed to set an example for brick kiln owners as they are made in the model and constructed in the same way as the brick kiln houses. The brick kiln houses are made of brick and are built in the same way as the brick kiln houses.

కార్మిక సంక్షేమం భేష్

ఇండ్లాండ్ బృందం ప్రశంస

కార్మిక సంక్షేమం కోసం అనేక కార్యక్రమాలు నిర్వహించబడ్డాయి. ఇందులో భాగంగా కార్మికులకు ప్రాథమిక వైద్య సౌకర్యం, విద్య, ఉద్యోగ సౌకర్యం అందించడం ప్రధాన లక్ష్యాలుగా నిర్ణయించబడ్డాయి. ఈ కార్యక్రమాలను విజయవంతంగా నిర్వహించడంలో ఇండ్లాండ్ బృందం ప్రత్యేకంగా ప్రశంస పొందింది.



మహిళా కార్మికులతో భేష్ సమావేశం, ఎంపీ చి. రాజ్ కుమార్ ప్రసంగం

మెడక్

ఆరోగ్య గృహ సముదాయాలు..!

ఆరోగ్య గృహ సముదాయాలు ఏర్పాటు చేయడం ద్వారా ప్రజల ఆరోగ్యం మెరుగుపడుతుంది. ఈ కార్యక్రమం ద్వారా ప్రజలకు ప్రాథమిక ఆరోగ్య సౌకర్యం అందించడం ప్రధాన లక్ష్యంగా నిర్ణయించబడింది. ఈ కార్యక్రమం విజయవంతంగా నిర్వహించబడింది.



ఆరోగ్య గృహ సముదాయం ప్రారంభం

సాక్షి 24/7

మెడక్

వర్కస్టేట్ పాఠశాలల పరిశీలన

వర్కస్టేట్ పాఠశాలల పరిశీలన కోసం ఒక బృందం ఏర్పాటు చేయబడింది. ఈ బృందం పాఠశాలలను పరిశీలించి, అవసరమైతే సరైన చర్యలు తీసుకోవడం ప్రధాన లక్ష్యంగా నిర్ణయించబడింది. ఈ బృందం విజయవంతంగా పనిచేసింది.



వర్కస్టేట్ పాఠశాలల పరిశీలన

ఒడిశా కార్మికుల శ్రేయస్ లక్ష్య

ఒడిశా కార్మికుల శ్రేయస్ కోసం ఒక బృందం ఏర్పాటు చేయబడింది. ఈ బృందం కార్మికులకు ప్రాథమిక వైద్య సౌకర్యం, విద్య, ఉద్యోగ సౌకర్యం అందించడం ప్రధాన లక్ష్యంగా నిర్ణయించబడింది. ఈ బృందం విజయవంతంగా పనిచేసింది.

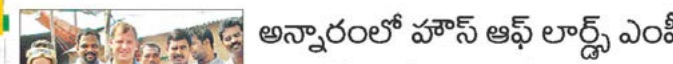

ఒడిశా కార్మికుల శ్రేయస్ కోసం బృందం ఏర్పాటు

ఆటక బట్టలను సందర్శించిన ఐదేశీయులు

ఆటక బట్టలను సందర్శించిన ఐదేశీయులు. ఈ కార్యక్రమం ద్వారా ఐదేశీయులకు ప్రాథమిక వైద్య సౌకర్యం అందించడం ప్రధాన లక్ష్యంగా నిర్ణయించబడింది. ఈ కార్యక్రమం విజయవంతంగా నిర్వహించబడింది.



ఆటక బట్టలను సందర్శించిన ఐదేశీయులు

అన్నారలో హౌస్ ఆఫ్ లార్డ్స్ ఎంపీ

అన్నారలో హౌస్ ఆఫ్ లార్డ్స్ ఎంపీ. ఈ కార్యక్రమం ద్వారా అన్నారలో ప్రజలకు ప్రాథమిక వైద్య సౌకర్యం అందించడం ప్రధాన లక్ష్యంగా నిర్ణయించబడింది. ఈ కార్యక్రమం విజయవంతంగా నిర్వహించబడింది.



అన్నారలో హౌస్ ఆఫ్ లార్డ్స్ ఎంపీ

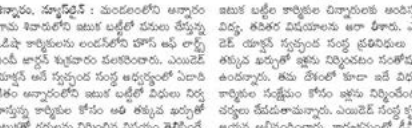

అన్నారలో హౌస్ ఆఫ్ లార్డ్స్ ఎంపీ



అన్నారలో హౌస్ ఆఫ్ లార్డ్స్ ఎంపీ

www.aea-southasia.org



Changing the world through Education

Aide et Action International South Asia (AEAI-SA)
H.No: 9, Pavani Villas, Dwarka Puri Colony, Punjagutta, Hyderabad - 500082
Andhra Pradesh, Office No: +91 40 2331 6128

Migration Information Resource Centre (MiRC)
a Thematic Unit of Aide et Action International - South Asia, HIG-119, Dharma Vihar, Khandagiri, Bhubaneswar, Odisha
Ph.: +91 674 2350503

design & print: binducreative